

FLOOD ZONE: This property lies in Flood Zones "C" and "V8" (el 10), according to F.I.R.M. (Flood Insurance rate map) Community Panel No. 120192 0119 B, dated Oct. 15, 1982. Panel 119 of 245.

NOTES:

- No title policy or commitment affecting title or boundary to the subject property has been provided. It is possible there are deeds and easements, recorded or unrecorded, which could affect the survey and boundaries. No search of the Public Records has been made by this office.
- Elevations shown hereon, if any, are in feet and decimal parts thereof and are based on NGVD-29.
- This plat is not valid unless sealed with an embossed surveyor's seal.
- This sketch cannot be transferred or assigned without the specific written permission of Wallace Surveying Corporation.
- Building ties shown hereon, if any, are not to be used for construction purposes.
- Bearings based on Florida State Plane Coordinate System Transverse Mercator East Zone 1973 Free Adjustment.

CERTIFICATION:

I HEREBY CERTIFY that the survey shown hereon meets the Minimum Technical Standards set forth by the Florida Board of Land Surveyors pursuant to Section 472.027, Florida Statutes, and adopted in Chapter 21 HH-6, Florida Administrative Code, effective September 1, 1981. Visible encroachments, if any, are as shown.

Craig L. Wallace
Professional Land Surveyor
Florida Certificate # 3357

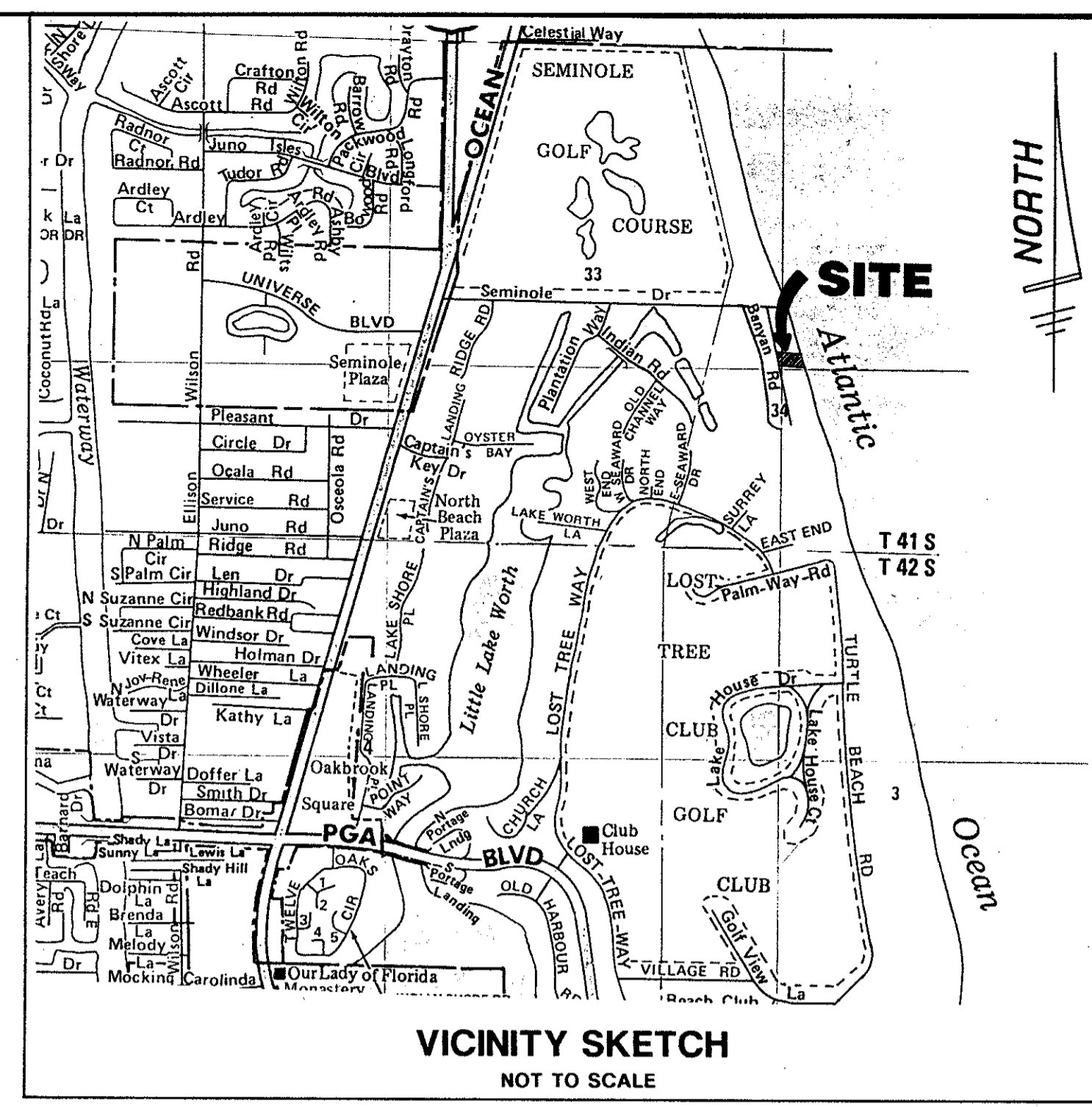

Parcel J-1

That certain tract of land situated in Section 34, Township 41 South, Range 43 East, described as follows:

Beginning at the Southwest corner of Lot No. Nine (9) of Seminole Club Addition, according to the plat thereof on file in the Office of the Clerk of the Circuit Court in and for Palm Beach County, Florida, in Plat Book 18 at Page 34 and running thence in a Southeasterly direction in the same direction as the prolongation of the East line of the Private Road as shown on said plat a distance of 50 feet for a Point of Beginning; thence continue along said line a distance of 125 feet; thence East parallel to the South line of Lot No. Nine (9) of said Seminole Club Addition to the waters of the Atlantic Ocean; thence Northerly along the waters of the Atlantic Ocean to a line extended Easterly from the Point of Beginning parallel to the South line of Lot No. Nine (9); thence West along said line parallel to the South line of Lot No. Nine (9) of said Addition to the Point of Beginning.

UJ 149

LEGEND			
A = Arc Length	ENC = Encroachment	P.B. = Page	⊕ = Borehole
ASPH = Asphalt	E.O.P. = Edge of Pavement	P.O.B. = Point of Beginning	⊖ = Contour
B.M. = Benchmark	ESMT = Easement	P.O.C. = Point of Commencement	Δ = Concrete Monument Found (as noted)
B.O.C. = Back of Curb	F.F. = Finish Floor	P.P.C. = Point of Reverse Curvature	■ = Concrete Monument Set (L.S. # 4559)
CA = Calculator	IM = Inside Measurement	P.R.M. = Permanent Reference Monument	□ = Rod & Cap Found (as noted)
C.A.T.V. = Cable Access Television	F.O.C. = Face of Curb	P.T. = Point of Tangency	○ = # 5 Rod & Cap Set (L.S. # 4559)
C.B. = Chord Bearing	I.D. = Inside Diameter	P.V.M. = Pavement	⊙ = Iron Pipe Found (as noted)
C.B.S. = Concrete Block Structure	INV. = Invert	R = Radius	⊙ = Iron Rod Found (as noted)
CL = Chord	M.H. = Manhole	RSE = Right of Way	⊙ = Parker-Kalon Nail Found
CLF. = Chain Link Fence	O.D. = Outside Diameter	RW = Right of Way	⊙ = Parker-Kalon Nail & Disk Found (as noted)
CONC. = Concrete	OH = Overhead Utility Line	S = Section	⊙ = Parker-Kalon Nail & Disk Set (L.S. # 4559)
(D) = Description Datum	O.R.B. = Official Record Book	SEC. = Section	⊙ = Property Line
D.S. = Dredge Stake	OP = Plat Datum	SNW = Snowbank	⊙ = Utility Pole
D.E. = Drillage Easement	P.B. = Plat Book	TWP. = Township	
D.H. = Ditch Hole	P.C. = Point of Curvature	TYP. = Typical	
D.W. = Ditchway	P.C.C. = Point of Compound Curvature	U.E. = Utility Easement	
EL. = Elevation	P.C.P. = Permanent Control Point	W.C. = Witness Corner	

BOUNDARY SURVEY FOR		
ARNOLD B. CHACE, Jr.		
WALLACE SURVEYING CORPORATION		
9176 ALTERNATE A1A, LAKE PARK, FLORIDA 33403 • 407/842-4233		
FIELD: J.P.	JOB NO.: 91-1335	FS 559 PG. 3/
OFFICE: R.C.	DATE: 1-29-92	DWG. NO.: 91-1335-1
CK'D: [Signature]	REF:	SHEET: 1 OF 1